

TL 싱크로 폴리 표준 치수표 (축홀가공 타입)

TN15형

(폴리 치형 치수)

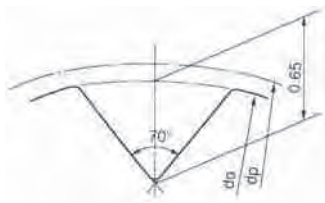

(폴리 형상)

AF 형

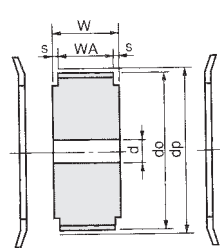

SF 형

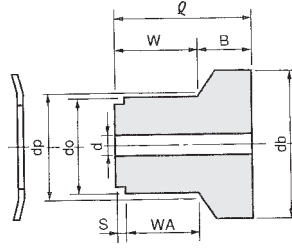

BF 형

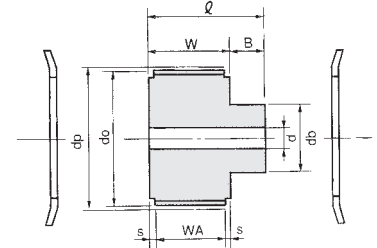

주문시 길이 100mm의 봉 형상 폴리도 제작합니다.

(폴리 호칭)

20 TN15-5.0 AF  
 폴리 잇수 (20개)      폴리 호칭 (TN15형)      폴리 호칭폭 (BELT폭5mm)  
 폴리 형상 (A형 플랜지 부착)

TN15-5.0 (벨트폭 5mm용)

비재고품

단위 : mm

| 잇수 | 형상    | 재질          | dp    | do    | W  |       | ℓ    | W A | S | B   | db | d   |        |     | PULLEY 예상질량 (g) |        | 플랜지 품 번 |
|----|-------|-------------|-------|-------|----|-------|------|-----|---|-----|----|-----|--------|-----|-----------------|--------|---------|
|    |       |             |       |       | SF | AF,BF |      |     |   |     |    | MAX |        | MIN | AF              | SF, BF |         |
|    |       |             |       |       |    |       |      |     |   |     |    | AF  | SF, BF |     |                 |        |         |
| 20 | AF,SF | 고 력 알루미늄 합금 | 9.55  | 8.91  | 8  | 10    | 14.5 | 6   | 2 | 6.5 | 13 | 4   | 4      | 3   | 1               | 4      | FM1306  |
| 22 | AF,SF |             | 10.50 | 9.86  | 8  | 10    | 14.5 | 6   | 2 | 6.5 | 14 | 5   | 5      | 3   | 2               | 4      | FM1407  |
| 24 | AF,SF |             | 11.46 | 10.82 | 8  | 10    | 14.5 | 6   | 2 | 6.5 | 14 | 5   | 5      | 4   | 2               | 4      | FM1407  |
| 26 | AF,SF |             | 12.41 | 11.77 | 8  | 10    | 14.5 | 6   | 2 | 6.5 | 16 | 7   | 5      | 4   | 2               | 6      | FM1609  |
| 28 | AF,SF |             | 13.37 | 12.73 | 8  | 10    | 14.5 | 6   | 2 | 6.5 | 17 | 8   | 6      | 4   | 3               | 7      | FM1710  |
| 30 | AF,SF |             | 14.32 | 13.68 | 8  | 10    | 14.5 | 6   | 2 | 6.5 | 17 | 8   | 6      | 4   | 3               | 7      | FM1710  |
| 32 | AF,SF |             | 15.28 | 14.64 | 8  | 10    | 14.5 | 6   | 2 | 6.5 | 18 | 9   | 6      | 5   | 4               | 8      | FM1811  |
| 34 | AF,BF |             | 16.23 | 15.59 | —  | 10    | 17.0 | 6   | 2 | 7   | 11 | 10  | 6      | 5   | 4               | 6      | FM2013  |
| 36 | AF,BF |             | 17.19 | 16.55 | —  | 10    | 17.0 | 6   | 2 | 7   | 11 | 10  | 6      | 5   | 5               | 6      | FM2013  |
| 40 | AF,BF |             | 19.10 | 18.46 | —  | 10    | 17.0 | 6   | 2 | 7   | 13 | 12  | 7      | 5   | 6               | 8      | FM2215  |
| 44 | AF,BF |             | 21.01 | 20.37 | —  | 10    | 17.0 | 6   | 2 | 7   | 14 | 12  | 8      | 5   | 8               | 10     | FM2516  |
| 48 | AF,BF |             | 22.92 | 22.28 | —  | 10    | 17.0 | 6   | 2 | 7   | 14 | 12  | 8      | 5   | 9               | 12     | FM2516  |
| 52 | AF,BF |             | 24.83 | 24.19 | —  | 10    | 17.0 | 6   | 2 | 7   | 15 | 15  | 8      | 5   | 10              | 14     | FM2919  |
| 56 | AF,BF |             | 26.74 | 26.10 | —  | 10    | 17.0 | 6   | 2 | 7   | 16 | 15  | 10     | 5   | 13              | 17     | FM3121  |
| 60 | AF,BF |             | 28.65 | 28.01 | —  | 10    | 17.0 | 6   | 2 | 7   | 16 | 15  | 10     | 5   | 15              | 19     | FM3422  |
| 64 | AF,BF |             | 30.56 | 29.92 | —  | 10    | 17.0 | 6   | 2 | 7   | 18 | 20  | 10     | 5   | 18              | 22     | FM3424  |
| 68 | AF,BF |             | 32.47 | 31.83 | —  | 10    | 17.0 | 6   | 2 | 7   | 18 | 20  | 10     | 5   | 20              | 25     | FM3727  |
| 72 | AF,BF |             | 34.38 | 33.74 | —  | 10    | 17.0 | 6   | 2 | 7   | 18 | 20  | 10     | 5   | 23              | 27     | FM3828  |
| 80 | AF,BF |             | 38.20 | 37.56 | —  | 10    | 17.0 | 6   | 2 | 7   | 20 | 25  | 14     | 5   | 29              | 34     | FM4328  |
| 88 | AF,BF |             | 42.02 | 41.38 | —  | 10    | 17.0 | 6   | 2 | 7   | 20 | 25  | 14     | 5   | 35              | 41     | FM4734  |
| 96 | AF,BF |             | 45.84 | 45.20 | —  | 10    | 17.0 | 6   | 2 | 7   | 20 | 25  | 14     | 5   | 42              | 47     | FM5136  |

TN15-10.0 (벨트폭 10mm용)

비재고품

단위 : mm

| 잇수 | 형상    | 재질                              | dp    | do    | W    |       | ℓ    | W A  | S | B   | db | d   |       |     | PULLEY 예상질량 (g) |       | 플랜지<br>품 번 |
|----|-------|---------------------------------|-------|-------|------|-------|------|------|---|-----|----|-----|-------|-----|-----------------|-------|------------|
|    |       |                                 |       |       | SF   | AF,BF |      |      |   |     |    | MAX |       | MIN | AF              | SF,BF |            |
|    |       |                                 |       |       |      |       |      |      |   |     |    | AF  | SF,BF |     |                 |       |            |
| 20 | AF,SF | 고<br>전<br>압<br>부<br>미<br>합<br>금 | 9.55  | 8.91  | 13.5 | 15.5  | 21   | 11.5 | 2 | 7.5 | 13 | 4   | 4     | 3   | 2               | 5     | FM1306     |
| 22 | AF,SF |                                 | 10.50 | 9.86  | 13.5 | 15.5  | 21   | 11.5 | 2 | 7.5 | 14 | 5   | 5     | 3   | 3               | 6     | FM1407     |
| 24 | AF,SF |                                 | 11.46 | 10.82 | 13.5 | 15.5  | 21   | 11.5 | 2 | 7.5 | 14 | 5   | 5     | 4   | 3               | 6     | FM1407     |
| 26 | AF,SF |                                 | 12.41 | 11.77 | 13.5 | 15.5  | 21   | 11.5 | 2 | 7.5 | 16 | 7   | 5     | 4   | 4               | 7     | FM1609     |
| 28 | AF,SF |                                 | 13.37 | 12.73 | 13.5 | 15.5  | 21   | 11.5 | 2 | 7.5 | 17 | 8   | 6     | 4   | 4               | 9     | FM1710     |
| 30 | AF,SF |                                 | 14.32 | 13.68 | 13.5 | 15.5  | 21   | 11.5 | 2 | 7.5 | 17 | 8   | 6     | 4   | 5               | 10    | FM1710     |
| 32 | AF,SF |                                 | 15.28 | 14.64 | 13.5 | 15.5  | 21   | 11.5 | 2 | 7.5 | 18 | 9   | 6     | 5   | 6               | 11    | FM1811     |
| 34 | AF,BF |                                 | 16.23 | 15.59 | —    | 15.5  | 22.5 | 11.5 | 2 | 7   | 11 | 10  | 6     | 5   | 7               | 8     | FM2013     |
| 36 | AF,BF |                                 | 17.19 | 16.55 | —    | 15.5  | 22.5 | 11.5 | 2 | 7   | 11 | 10  | 6     | 5   | 8               | 9     | FM2013     |
| 40 | AF,BF |                                 | 19.10 | 18.46 | —    | 15.5  | 22.5 | 11.5 | 2 | 7   | 13 | 12  | 7     | 5   | 10              | 12    | FM2215     |
| 44 | AF,BF |                                 | 21.01 | 20.37 | —    | 15.5  | 22.5 | 11.5 | 2 | 7   | 14 | 12  | 8     | 5   | 12              | 15    | FM2516     |
| 48 | AF,BF |                                 | 22.92 | 22.28 | —    | 15.5  | 22.5 | 11.5 | 2 | 7   | 14 | 12  | 8     | 5   | 15              | 17    | FM2516     |
| 52 | AF,BF |                                 | 24.83 | 24.19 | —    | 15.5  | 22.5 | 11.5 | 2 | 7   | 15 | 15  | 8     | 5   | 18              | 20    | FM2919     |
| 56 | AF,BF |                                 | 26.74 | 26.10 | —    | 15.5  | 22.5 | 11.5 | 2 | 7   | 16 | 15  | 10    | 5   | 21              | 24    | FM3121     |
| 60 | AF,BF |                                 | 28.65 | 28.01 | —    | 15.5  | 22.5 | 11.5 | 2 | 7   | 16 | 15  | 10    | 5   | 24              | 27    | FM3422     |
| 64 | AF,BF |                                 | 30.56 | 29.92 | —    | 15.5  | 22.5 | 11.5 | 2 | 7   | 18 | 20  | 10    | 5   | 28              | 32    | FM3424     |
| 68 | AF,BF |                                 | 32.47 | 31.83 | —    | 15.5  | 22.5 | 11.5 | 2 | 7   | 18 | 20  | 10    | 5   | 31              | 36    | FM3727     |
| 72 | AF,BF |                                 | 34.38 | 33.74 | —    | 15.5  | 22.5 | 11.5 | 2 | 7   | 18 | 20  | 10    | 5   | 35              | 40    | FM3828     |
| 80 | AF,BF |                                 | 38.20 | 37.56 | —    | 15.5  | 22.5 | 11.5 | 2 | 7   | 20 | 25  | 14    | 5   | 44              | 50    | FM4328     |
| 88 | AF,BF |                                 | 42.02 | 41.38 | —    | 15.5  | 22.5 | 11.5 | 2 | 7   | 20 | 25  | 14    | 5   | 54              | 60    | FM4734     |
| 96 | AF,BF |                                 | 45.84 | 45.20 | —    | 15.5  | 22.5 | 11.5 | 2 | 7   | 20 | 25  | 14    | 5   | 65              | 70    | FM5136     |